

THE PALM CLUB WEST VILLAGE II
PART OF LAKESIDE GREEN
(P.B. 50, PAGES 106-107)

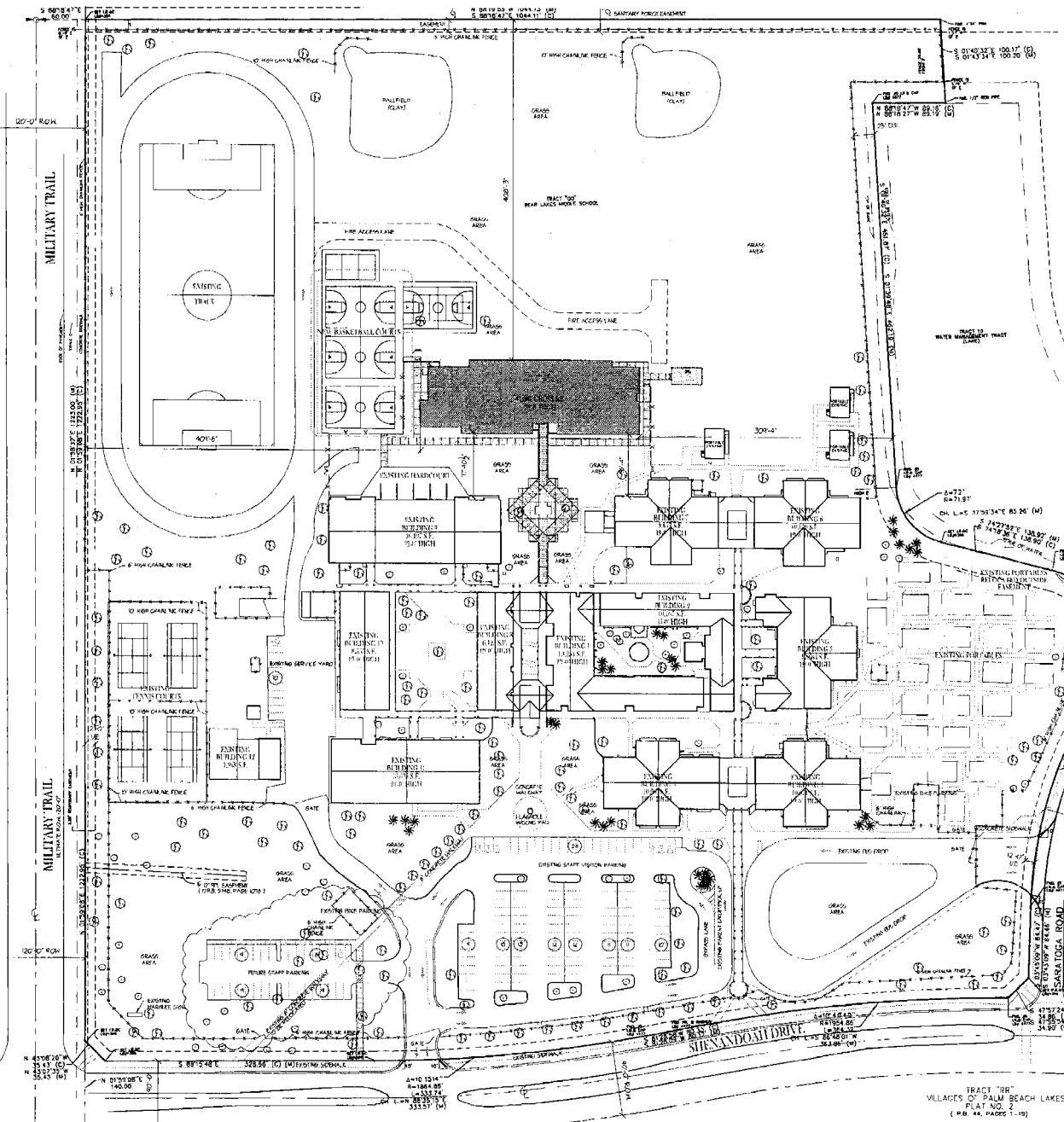

TABULAR DATA		
PETITION NUMBER	NONE FOUND	
NAME OF PROJECT	BEAR LAKES MIDDLE SCHOOL, PUBLIC	
PROPOSED USE	PUBLIC SCHOOL	
FUTURE LAND USE DESIGNATION	COMMUNITY SERVICE	
ZONING DISTRICT		
SECTION OR PARCEL	12 / 43 / 42	
PRECEDENT CONTROL NO.	14-42-43-12-03-002-0170	
TOTAL GROSS ACRES ± SF	30.43 / 1,325,500	
STUDENT STATIONS	1,000	
TOTAL PARKING SF	123,62 SF	
TOTAL PROPOSED CLASSROOM ADDITION SF	2,304 SF (4,504 S.F. GROSS)	
FLOOR AREA RATIO (FAR)	20%	
BUILDING COVERAGE	84%	
BUILDING HEIGHT (MAX)	37'-6"	
NO. OF STOREY FLOORS	2 (PROPOSED BUILDING)	
FINISHED GRADE ELEVATION	FF 10.00 EXISTING & PROPOSED	
PARKING TABULATION		
	REQUIRED PER GRF	PROPOSED
STAFF / FACULTY	176	100
VISITOR	12	15
EXTRACURRICULAR ACTIVITIES	8	4
IC PARKING (EXISTING)	1	1
TOTAL	64	131

STANFORD AT THE VILLAGES
OF PALM BEACH LAKES
(P.B. 82, PAGES 141-148)

SITE LOCATION MAP

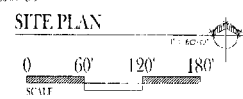

SITE PLAN

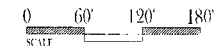

TRACT "DB"
VILLAGES OF PALM BEACH LAKES
PLAT NO. 2
(P.B. 44, PAGES 7-10)

APPROVAL STAMP

tercila *cowymanche* architects

Class Size Reduction
Bear Lakes Middle School
SDPBC Project No. 1941-8050
The School District of Palm Beach County
West Palm Beach, Florida

commission 24035
 date 03/01/05
 revision
 no.
 drawing
 DRC
 copyright 2005

AA PROJECT
3043-000000-plot1, 000000
www.tercila.com, www.cowymanche.com
www.palmbeachschools.org, www.sdbpc.org
tel: 561.844.4384, fax: 561.458.4102